

 SUPPORT PIER

NOTE:
 PERIMETER BLOCKING ONLY REQUIRED FOR 30#
 AND 40# ROOF LOADS.

FOUNDATION NOTES:

1. PIER LOCATIONS INDICATED ARE FOR REFERENCE ONLY. REFER TO INSTALLATION MANUAL FOR ADDITIONAL REQUIRED LOCATIONS SUCH AS FOR OPTIONAL ITEMS LIKE FIREPLACES OR ALTERNATIVE PIER SPACINGS AND ROOF LOADS.
2. SINGLE STACKED PIERS LESS THAN 36" HIGH.
3. DOUBLE STACKED PIERS 36" TO 67" HIGH.
4. UTILITY LOCATIONS ARE "GENERAL" AND IF AN EXACT DIMENSION IS REQUIRED PLEASE VERIFY WITH SPECIFIC HOME SERIAL NUMBER.

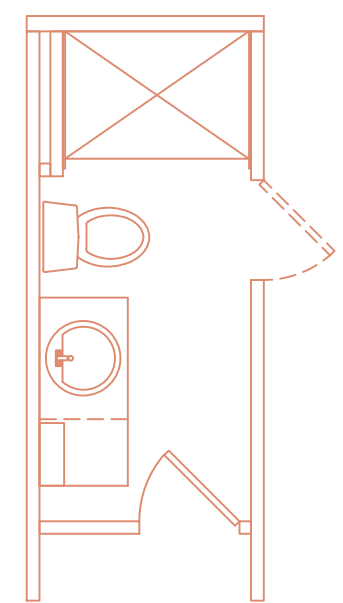

Legacy Housing

DATE: 01/28/2016 MODEL: 1660-22A
 SCALE: NTS DRAWN BY: JMS

TITLE: FOUNDATION PLAN		DWG #:	
REF #	DESCRIPTION	DATE	REVISED BY: