

Opt. Dishwasher Configuration

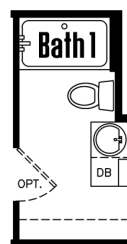

Optional Bumpout

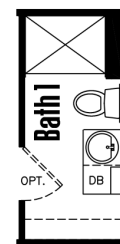

Opt. Master Bath Shower Configuration

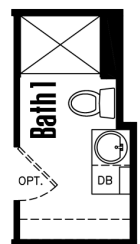

FOR MORE FLOORPLANS



**Certified.**  
**ENERGY-EFFICIENT**

Copyright © 2005-2024  
Legacy Housing Corporation - Nasdaq: LEGH

VIEW HOME PHOTOS ONLINE AT  
[WWW.LEGACYHOUSINGUSA.COM](http://WWW.LEGACYHOUSINGUSA.COM)

FIND A DEALER NEAR YOU  
**(877) 652-3322**



# ENERGY STAR BENEFITS

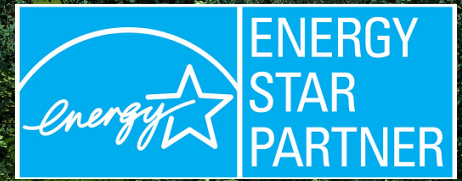

## LEGACY'S ENERGY EFFICIENT OPTIONS INCLUDE:



## **NEW** SMART DOORBELL

- ✓ Thermal Zone II Certification
- ✓ Mini-Split Unit 21 SEER
- ✓ Radiant Barrier OSB
- ✓ Low E Windows
- ✓ R22 Floor & R31 Ceiling w/ Blown Insulation

- Converse with anyone at your doorstep through our Smart Doorbell and your smartphone from anywhere in the world.
- Elevate your communication with Two-Way Audio, creating seamless conversations and connections with whoever is at your doorstep.
- Stay steps ahead with Motion Detection, ensuring instant alerts and enhanced security, giving you peace of mind day and night.

Available on all Legacy Models for 2024

FIND A DEALER NEAR YOU  
**(877) 652-3322**